

Proposal for a new construction: bioclimatic chalet

Alicante, Javea

Reserved

🏠 200 m² Living Area 🛋️ 2 Living Rooms 🛏️ 3 Bedrooms 🚿 2 Bathrooms

ID1/1434

Price on request

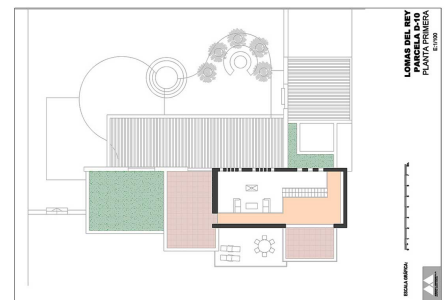
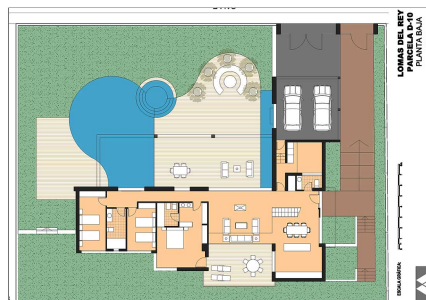

Description

This project located in Jávea with a house of 200 m² on a plot of 1,000 m², with fantastic views, surrounded by the Natural Park of Granadella and 3 km from the beach, will be built according to your wishes and will adapt to your tastes.





You can access the villa through the stairs of the main entrance or through the garage. When passing through the hall you can either access the dining room that will take you to a fully equipped American kitchen, or to the living room with large windows and views of the Montgó. From here you can access the roof terrace and the pool. Both the living room and the kitchen have direct access to a terrace of 25m². Just behind the living room is the day part with 3 bedrooms, one of them with bathroom en suite and the other two with a shared bathroom. There are stairs leading from the main entrance to a room of 21m² with large windows and access to another terrace.

A spectacular pool with a stone wall as in the images.





General

- Living Area: 200m²
- Plot: 1000m²
- Floors: 2
- Bedrooms: 3
- Bathrooms: 2
- Living rooms: 2
- Year of construction: XXXX
- Condition: new
- Mountain View
- Open views
- km. to the sea: 3
- km. to the city center: 4
- km. to the supermarket: 3

Outdoor

-  Pool
-  Private garden
-  Parking space
-  Covered terrace
-  Terrace

Indoor

-  Air Conditioner
-  Heating
-  Fireplace
-  Guest WC

Additional

-  Security door